



**SUBMITTAL DATA – WALL-MOUNTED
LM09HO-100T432-1 – LM09HI-100T432-1
SINGLE ZONE MINI-SPLIT HEAT PUMP**

Job: _____
Location: _____
Schedule No.: _____
System Designation: _____

Engineer: _____
Architect: _____
Date: _____

FEATURES

Outdoor Unit: **LM09HO-100T432-1**
Outdoor Unit Cat Number: **Y6769**

Indoor Unit: **LM09HI-100T432-1**
Indoor Unit Cat Number: **Y6768**



- 3 Meter Copper Pipe Included

- Auto Restart
- Four Selectable Fan Speeds
- Hidden LED Display
- Wireless Remote Included
- I Feel Function
- Health Function

PIPING

Line Set and Elevation Guidelines	
Maximum Line Set Length ft. (m)	49.2 ft. (15 m)
Maximum Elevation - Outdoor Unit Below/Above Indoor Unit ft. (m)	32.8 ft. (10 m)
Liquid Line Set Diameter (in.)	1/4"
Gas Line Set Diameter (in.)	3/8"

PRODUCT WARRANTY

5 Year Limited Warranty*

OPTIONAL ACCESORIES

Filter



NOTE – Due to Lennox' ongoing commitment to quality, Specifications, Ratings, and Dimensions are subject to change without notice and without incurring liability. Improper installation, adjustment, alteration, service or maintenance can cause property damage or personal injury. Installation and service must be performed by a qualified installer and servicing agency



**SUBMITTAL DATA – WALL-MOUNTED
LM09HO-100T432-1 – LM09HI-100T432-1
SINGLE ZONE MINI-SPLIT HEAT PUMP**

OUTDOOR SPECIFICATIONS

PERFORMANCE	
Cooling Capacity (Btu/h)	9,000
EER(W/W)	3.21
SEER(BTUH/W)	/
Heating Capacity (Btu/h)	9,400
COP	3.61

Outdoor Fan Total Air Volume (CFM)	706
Ambient Temperature Operating Range	
Cooling	64°F(18°C) - 109°F(43°C)
Heating	19°F(-7°C) - 75°F(24°C)

ELECTRICAL DATA	
Power Supply (V/Hz/ϕ)	Supplied by IDU
Minimum Circuit Ampacity (A)	/
Maximum Overcurrent Protection (A)	/
Outdoor Fan Motor RLA (A)	.3
Compressor RLA (A)	3.9
No. of Compressors	1

GENERAL DATA	
Connection Ratio (%)	100%
Max. # of Indoor Units	1
Sound Data (dBA) - Cooling/Heating	50
Refrigerant type	R-410A
Factory refrigerant charge	1.37 lbs. 21.9 oz.

DIMENSIONS		
Unit Dimensions (in)	Height	16.9
	Width	28.3
	Depth	12.2
Shipping Weight (lb)		61.7
Net Weight (lb)		57.3

NOTES
1. Cooling and Heating Capacity data is rated at the following conditions:
Cooling: 80°FDB / 67°F WB Indoor, 95°FDB/75°F WB Outdoor
Heating: 68°FDB / 59°F WB Indoor, 45°FDB/ 43°F WB Outdoor

OUTDOOR DIMENSIONAL DRAWINGS - INCHES (MM)

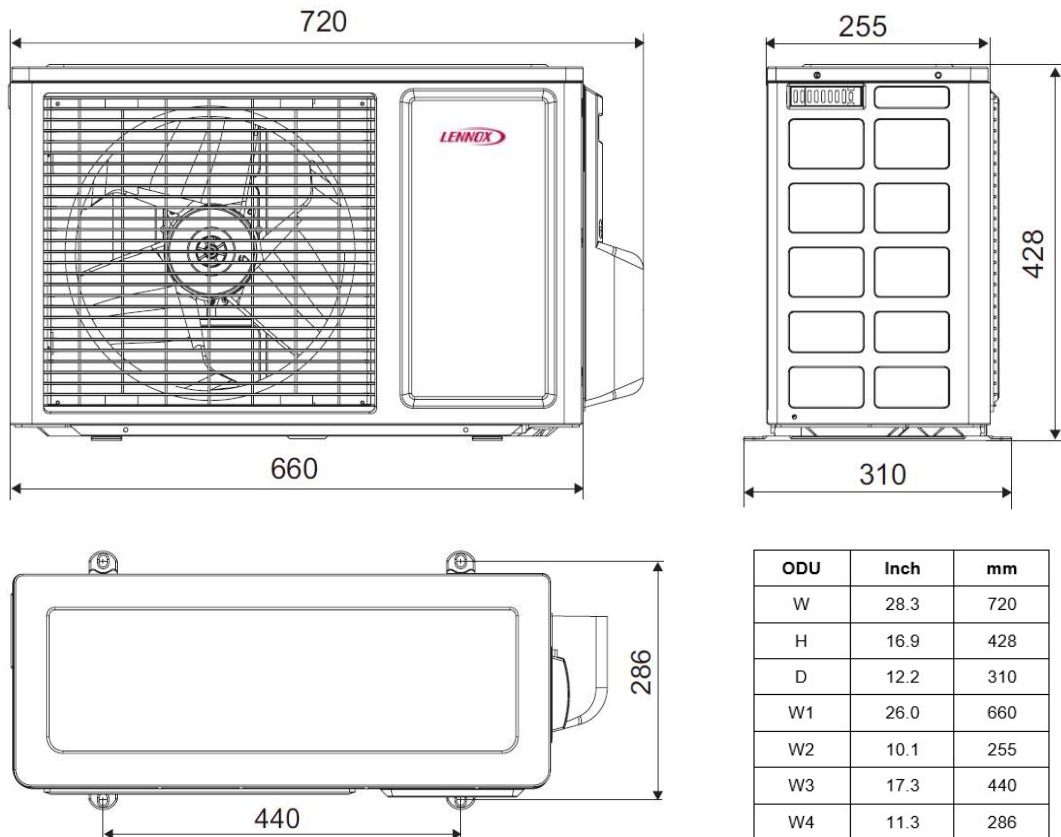

NOTE – Due to Lennox’ ongoing commitment to quality, Specifications, Ratings, and Dimensions are subject to change without notice and without incurring liability. Improper installation, adjustment, alteration, service or maintenance can cause property damage or personal injury. Installation and service must be performed by a qualified installer and servicing agency



**SUBMITTAL DATA – WALL-MOUNTED
LM09HO-100T432-1 – LM09HI-100T432-1
SINGLE ZONE MINI-SPLIT HEAT PUMP**

INDOOR SPECIFICATIONS

PERFORMANCE			
Airflow (CFM)	Turbo		312
	High		288
	Medium		253
	Low		194
External Static Pressure (in. w.g.)			-
Sound Pressure (dBA)	Turbo		39
	High		35
	Medium		32
	Low		28

ELECTRICAL DATA	
Power Supply (V/Hz/ϕ)	220-240/50/1
Rated load amps (RLA)	.215
Power Output (W)	20

DIMENSIONS			
Unit Dimensions (in)	Height		10.8
	Width		31.1
	Depth		7.9
Unit Net/Shipping Weight (lb)			19.8/24.3

WIRELESS REMOTE CONTROLLER SPECIFICATIONS

Y6185	
Power Supply	2 AAA Batteries (Included)
Setpoint Range	61°F(16°C) - 86°F(30°C)
Effective Receiving Range	26 ft.(8m)

DISPLAY

I feel
 Función de calefacción 8° C
 Modo de operación
 Modo automático
 Modo de enfriamiento
 Modo de secado
 Modo de ventilación
 Modo calentamiento
 Reloj
 Modo reposo
 Luz
 Tipo de temperatura mostrada
 Temperatura ajustada
 Temperatura ambiente interior
 Temperatura ambiente exterior
 Ajuste de la velocidad del ventilador
 Enviar señal
 Modo turbo
 Operación de ventilación
 Función de saludable
 Modo X - fan
 Temperatura ajustada
 Tiempo ajustado
 Temporizador activado / Temporizador desactivado
 Bloqueo infantil
 Dirección arriba y abajo

INDOOR DIMENSIONAL DRAWINGS - INCHES (MM)

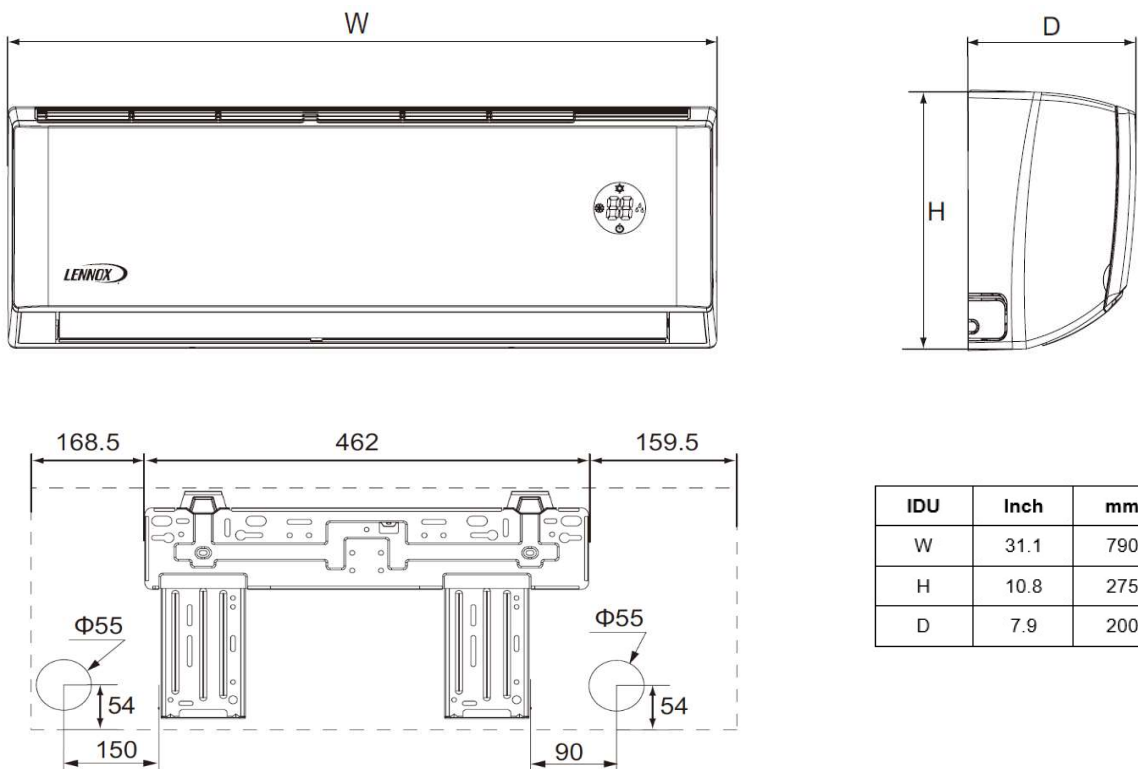

NOTE – Due to Lennox' ongoing commitment to quality, Specifications, Ratings, and Dimensions are subject to change without notice and without incurring liability. Improper installation, adjustment, alteration, service or maintenance can cause property damage or personal injury. Installation and service must be performed by a qualified installer and servicing agency